

NOR-LAKE SCIENTIFIC
727 Second Street
P.O. Box 248
Hudson, Wisconsin 54016

800-477-5253
715-386-2323
800-388-5253 PARTS
715-386-4290 FAX
www.norlake.com

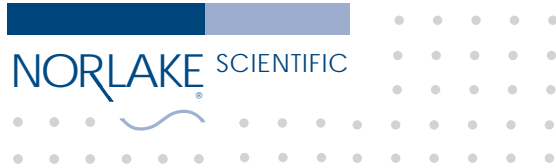

MINI-ROOM WALK-IN CONTROLLED TEMPERATURE CHAMBERS/STABILITY CHAMBERS



Specially designed to reproduce a desired environment. Applications include: Stability storage, biological research, shelf life testing and many other uses. 10,000 Models Available to Ship in Seven Days.

STANDARD FEATURES

- Temperatures: +4°C., -20°C., -30°C., 0°C. to 55°C. (ideal for stability testing at 25°C and 40°C.)
- Capsule-Pak™ refrigeration system (ceiling or wall mount)
- Air-cooled condensing unit
- 26 gauge embossed galvanized with aluminum coating on all surfaces except interior floor
- Smooth aluminum interior floor (on models with floor)
- Floorless models supplied with NSF listed vinyl sealers
- Stocked for 7 day shipment
- Full 4" thick panels foamed-in-place with HFC-134a polyurethane insulation which is CFC and HCFC free
- 26" wide, self-closing doors
- Two heavy duty cam-lift hinges per door (hydraulic closer)
- Posi-close door closer
- Deadbolt locking handle with independent key/padlock feature and inside safety release
- Magnetic gasket
- Dial thermometer
- Floor double sweep gasket
- Perimeter heater wire
- Vapor-proof light with constant burning night light feature
- Switch and pilot light
- Registered by UL to ISO 9001
- NSF, UL flame spread 25 on all panels; UL and CSA electrical listing on door sections
- UL and CSA electrical listing on complete Capsule-Pak™ refrigeration systems
- City of New York (MEA) listed
- City of Houston listed
- Oregon State listed
- City of LA listed
- California State listed
- USDA accepted
- Fifteen year panel warranty
- Five year compressor warranty
- One year labor/service warranty

STANDARD FEATURES

- INDOOR MODELS:**
- Hot gas condensate vaporizer
- OUTDOOR MODELS:**
- White membrane roof and trim
 - Refrigeration hood
 - Door hood (optional)
 - -30°C. ambient controls

OPTIONAL FEATURES*

- Microprocessor based control panel
- Chart recorder
- Humidification (available on 0°C. to 55°C. rooms only. Provides ambient to 95% at 4°C. - 40°C., and 90% at 41°C. - 55°C.)
- Duplex electrical outlets
- Hi/Lo alarm
- Viewport door

OPTIONAL FEATURES**

- U-shaped shelving system
- Shelving system ledges
- Floor treadplate kit
- Exterior ramp
- Condensing unit air deflector kit
- Heater kit for cooler located outdoors in below 0°C. ambient
- Leak detector/alarm (may be a requirement in some areas)
- Transformer kit
- Water-cooled condensing unit
- Three phase electrical
- Remote Capsule-Pak™ refrigeration systems



Nor-Lake, Inc.
Registered to ISO 9001
File No. A3204

MINI-ROOM REFRIGERATORS, FREEZERS & COMBINATIONS

*Options ship in 10 working days (Top mount refrigeration only).

**Most options are available 10 working days from receipt of order. Please contact us for specific questions.

SPECIFICATION

GUIDE

REMOTE CAPSULE PAK™ REFRIGERATION SYSTEMS

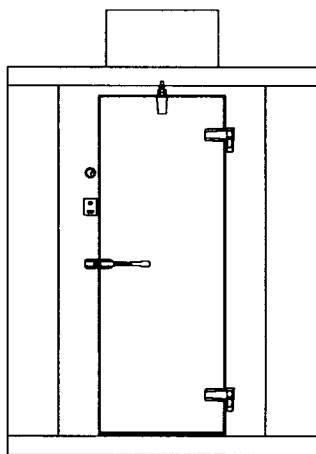

OPTIONAL FLOOR TREAD PLATE SPECIFICATIONS

Floor Tread Plate Kits of 1/8" high tensile strength aluminum diamond tread plate are precut to fit interior floor space of any Mini-Room model. Offers superior corrosion resistance and provides additional protection to the interior floor surface for applications requiring heavy product load. Installation of tread plate floor kit is completed by the equipment installer.

OPTIONAL EXTERIOR RAMP

Exterior ramp with overall dimensions of 36 wide and extends 25 1/2" from the front of the walk-in. The ramp surface will rise at a 8 degree angle from the finished customer floor to the 4" height of the interior walk-in floor. Ramp and door threshold are designed to allow the ramp to removable when not in use.

OPTIONAL HEATER KIT

When a Mini-Room refrigerator is installed outdoors, in a location where the ambient temperature can be below freezing for extended periods of time, it may be necessary to add heat to the interior compartment to avoid the freezing of product. In these cases the Mini-Room can include a heater kit which consists of a 2 1/2" deep x 30" long base board heater. The heater is 120 volt, 750 watt, and draws 6.5 AMPS. The base board heater shall be field installed to the interior wall, at floor level, and located in an area which doesn't interfere with product storage. A medium temperature thermostat is included with the kit and is wired to the base board heater and set to the desired cooler temperature. It is recommended that the heater system is wired to a separate electrical breaker which can be turned off in the warm seasons of the year. This will eliminate any chance of accidental movement of the thermostat adjustment and possible spoiling of product.

Remote Capsule-Pak™ Refrigeration Systems

CEILING MOUNT SYSTEMS

Model Number	REF.	Refrig. Opening Size	CONDENSING UNIT			EVAPORATOR UNIT					
			Voltage	Cond Amps	Min. Circuit Amps	Max. Fuse Size	Voltage	Defrost Amps	Evap Amps	Min. Circuit Amps	Max. Fuse Size
RCPB0501C-A-x	R22	SMALL	115/60/1	15	18.4	30	115/60/1	N/A	1	1.3	15
RCPB050DC-A-x	R404	SMALL	115/60/1	10.7	13.2	20	115/60/1	N/A	1	1.3	15
RCPB0751C-A-x	R22	MEDIUM	208-230/60/1	8	9.8	15	230/60/1	N/A	0.9	1.1	15
RCPB075DC-A-x	R404	MEDIUM	208-230/60/1	8.8	10.7	15	230/60/1	N/A	1.2	1.5	15
RCPB100DC-A-x	R404	LARGE	208-230/60/1	12.1	14.9	25	230/60/1	N/A	1	1.3	15
RCPF060DC-A-x	R404	MEDIUM	208-230/60/1	8.8	10.7	15	115/60/1	13.3	1.8	13.3	15
RCPF075DC-A-x	R404	MEDIUM	208-230/60/1	6.3	7.6	15	115/60/1	13.3	1.8	13.3	15
RCPF100DC-A-x	R404	LARGE	208-230/60/1	8	9.7	15	230/60/1	8.7	1	8.7	15
RCPF150DC-A-x	R404	LARGE	208-230/60/1	12.5	15	20	230/60/1	8.7	1	8.7	15

WALL MOUNT SYSTEMS

RCPB050DW-A-x	R404	SMALL	115/60/1	10.7	13.2	20	115/60/1	N/A	1.8	2.3	15
RCPB075DW-A-x	R404	LARGE	208-230/60/1	8.8	10.7	15	230/60/1	N/A	1	1.3	15
RCPF060DW-A-x	R404	SMALL	208-230/60/1	8.8	10.7	15	115/60/1	6.7	1.3	6.7	15
RCPF075DW-A-x	R404	SMALL	208-230/60/1	6.3	7.6	15	115/60/1	8.3	1.3	8.3	15
RCPF100DW-A-x	R404	LARGE	208-230/60/1	8	9.7	15	230/60/1	7.1	1	7.1	15
RCPF150DW-A-x	R404	LARGE	208-230/60/1	12.5	15	20	230/60/1	7.1	1	7.1	15

x=Enter the desired line length (5 Feet to 50 Feet)

These systems include ambient controls, weather-proof hoods, precharged systems with quick connects for simple field connections to precharged lines of your choice. Consult factory for application, pricing and ship date availability.

Capsule-Pak™ Refrigeration System Specifications



Capsule-Pak™ refrigeration systems consist of a unitized system which is factory assembled, wired, charged, tested and fully equipped for insertion into a factory prepared walk-in opening. Models shall be available for wall or ceiling mounting for use on indoor or outdoor installations. Models are available for interior compartment design temperatures of +4°C., -20°C., -30°C., and 0° to 55°C.

The Capsule-Pak™ system evaporator section shall consist of an integral factory assembled component of the complete Capsule-Pak™ refrigeration system. The evaporator section shall be designed as to be located entirely outside the walk-in with no intrusions into the refrigerated space. The evaporator enclosure shall be constructed utilizing foamed-in-place polyurethane insulation and be equipped with a removable, gasketed access cover.

All indoor Capsule-Pak™ models shall be equipped with a discharge gas condensate vaporizer which requires no plumbing. All outdoor Capsule-Pak™ models shall be equipped with low ambient controls consisting of crankcase heater, flooded condenser head pressure control and pumpdown cycle.

All standard Capsule-Pak™ refrigeration systems are stocked for 7 day shipment.

All standard Capsule-Pak™ refrigeration systems shall be listed, approved or certified by U.L. (Underwriters Laboratories) and C.S.A. (Canadian Standards Association).

Note: Allow a minimum of 6" clearance above the Capsule Pak™ system .

Capsule-Pak™ Refrigeration Systems

Model Number	Horsepower	Volts/Hz/Ph	Defrost AMPS	Total System AMPS	Minimum Circuit AMPS	Maximum Fuse Size
CPBO501C-A	1/2	115/60/1	N/A	11.0	11.6	20
CPBM0501C-A	1/2	115/60/1	N/A	11.0	11.6	20
CPB0751C-A	3/4	208-230/60/1	N/A	8.7	10.5	15
CPBM0751C-A	3/4	208-230/60/1	N/A	8.7	10.5	15
CPBO501CO-A	1/2	115/60/1	N/A	14.5	17.3	25
CPB0751CO-A	3/4	208-230/60/1	N/A	9.1	10.9	15
CPWM0501C-A	1/2	115/60/1	N/A	19.7	21.7	25
CPWM0751C-A	3/4	208-230/60/1	N/A	17.1	18.9	25
CPB050DC-A	5/8	115/60/1	N/A	11.7	14.2	20
CPBM050DC-A	1/2	115/60/1	N/A	11.7	14.2	20
CPWM050DC-A	1/2	115/60/1	9.2	21.1	23.6	30
CPB075DC-A**	7/8	208-230/60/1	N/A	10.0	11.9	15
CPBM075DC-A**	3/4	208-230/60/1	N/A	10.0	11.9	15
CPWM075DC-A	3/4	208-230/60/1	7.1	17.7	19.6	25
CPB100DC-A	1	208-230/60/1	N/A	13.1	15.9	25
CPBM100DC-A	1	208-230/60/1	N/A	13.1	15.9	25
CPWM100DC-A	1	208-230/60/1	10.4	23.5	26.3	35
CPF060DC-A	5/8	208-230/60/1	13.4	10.7	13.4	20
CPFM060DC-A	3/4	208-230/60/1	13.4	10.1	13.4	15
CPF075DC-A**	3/4	208-230/60/1	13.4	8.2	13.4	15
CPFM075DC-A**	3/4	208-230/60/1	13.4	8.2	13.4	15
CPF100DC-A	1	208-230/60/1	8.8	9.1	10.8	15
CPFM100DC-A	1	208-230/60/1	8.8	9.1	10.8	15
CPF150DC-A	1 1/2	208-230/60/1	8.8	13.6	16.1	25
CPFM150DC-A	1 1/2	208-230/60/1	8.8	13.6	16.1	25
CPX100DC-A**	1	208-230/60/1	13.4	9.9	13.4	15
CPXM100DC-A**	1	208-230/60/1	13.4	9.9	13.4	15
CPX150DC-A*	1 1/2	208-230/60/1	12.6	13.6	16.1	25
CPXM150DC-A*	1 1/2	208-230/60/1	12.6	13.6	16.1	25
CPX151DC-A	1 1/2	230/60/1	12.7	13.7	16.2	25
CPB050DCO-A	5/8	115/60/1	N/A	12.1	14.6	20
CPB075DCO-A**	7/8	208-230/60/1	N/A	10.2	12.1	15
CPB100DCO-A	1	208-230/60/1	N/A	13.3	16.1	25
CPF060DCO-A	5/8	208-230/60/1	13.8	11.1	13.8	20
CPF075DCO-A**	3/4	208-230/60/1	13.5	8.3	13.5	15
CPF100DCO-A	1	208-230/60/1	9.0	9.3	11.0	15
CPF150DCO-A	1 1/2	208-230/60/1	9.0	13.8	16.3	25
CPF151DCO-A	1 1/2	230/60/1	9.0	13.9	16.4	25
CPB050DW	1/2	115/60/1	N/A	12.5	15.0	25
CPB075DW**	3/4	208-230/60/1	N/A	9.8	11.7	15
CPB100DW	1	208-230/60/1	N/A	13.1	15.9	25
CPF060DW	5/8	208-230/60/1	6.7	10.1	12.0	15
CPF075DW**	3/4	208-230/60/1	8.3	7.6	8.9	15
CPF100DW	1	208-230/60/1	7.1	9.0	10.7	15
CPF150DW	1 1/2	208-230/60/1	7.1	13.5	16.0	25
CPX100DW**	1	208-230/60/1	8.3	9.3	11.0	15
CPX150DW	1 1/2	208-230/60/1	7.1	13.5	16.0	25
CPX151DW	1 1/2	230/60/1	7.1	13.6	16.1	25
CPB050DWO	1/2	115/60/1	N/A	13.1	15.6	25
CPB075DWO**	3/4	208-230/60/1	N/A	10.1	12.0	15
CPB100DWO	1	208-230/60/1	N/A	13.4	16.2	25
CPF060DWO	5/8	208-230/60/1	7.0	10.4	12.3	20
CPF075DWO**	3/4	208-230/60/1	8.6	7.9	9.2	15
CPF100DWO**	1	208-230/60/1	7.4	9.3	11.0	15
CPF150DWO**	1 1/2	208-230/60/1	7.4	13.8	16.3	25
CPF151DWO**	1 1/2	230/60/1	7.4	13.9	16.4	25

NOTE: Each door section requires separate 115/60/1 hook up and draws 2.3 AMPS.

*Hot gas defrost

**These symbols have 115 volt fan motors and/or drain line heaters which will require 115/60/1 service

Physical Specifications

OUTDOOR MODELS:

All Mini-Room walk-ins installed outdoors include a weather protection kit consisting of: One piece, 35 mill, white membrane roof material which requires no seaming or gluing to the top of the Mini-Room walk-in ceiling panels.



Plastic strips for flashing the membrane roof material to the side of the Mini-Room walk-in wall panels are included.



Trim is secured to the Mini-Room wall panels with self drilling and self tapping TEK screws. In applications where the

Mini-Room walk-in is installed next to a building, the straight trim can be used to secure the turned up membrane roof material to the building wall, with fasteners supplied by the equipment installer. Above door rain hoods are an option and should be included on installations where the door panels are exposed to the outdoor weather.

APPROVALS:

Mini-Room walk-in construction is approved by the National Sanitation Foundation and shall have the N.S.F. seal on the door section. Walk-in panels shall have a U.L. flame spread rating of 25. The door section is U.L. and C.S.A. listed for electrical safety.

- Registered by UL to ISO 9001
- City of New York (MEA) listed
- City of Houston listed
- Oregon State listed
- California State listed
- City of LA listed
- USDA accepted



Nor-Lake, Inc.
Registered to ISO 9001
File No. A3204

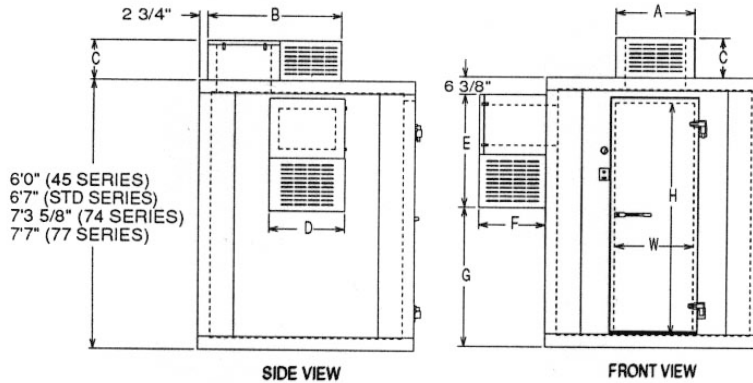

Door Opening Sizes

W	H	Model
26"	59"	45 Series
26"	66"	STD Series
26"	78"	74 Series
26"	78"	77 Series

Capsule-Pak™ Refrigeration Systems

"G" DIMENSION

Model Number	"A"	"B"	"C"	"D"	"E"	"F"	45 Series	Std. Series	74 Series	77 Series
CPB0501C-A	26"	44 1/2"	13 1/2"	N/A	N/A	N/A	N/A	N/A	N/A	N/A
CPBM0501C-A**	26"	44 1/2"	13 1/2"	N/A	N/A	N/A	N/A	N/A	N/A	N/A
CPB0751C-A	37"	48 1/4"	13 1/2"	N/A	N/A	N/A	N/A	N/A	N/A	N/A
CPBM0751C-A**	37"	48 1/4"	13 1/2"	N/A	N/A	N/A	N/A	N/A	N/A	N/A
CPB0501CO-A	32"	44 1/2"	14 7/8"	N/A	N/A	N/A	N/A	N/A	N/A	N/A
CPB0751CO-A	43"	48 1/4"	14 7/8"	N/A	N/A	N/A	N/A	N/A	N/A	N/A
CPWM0501C-A	37"	44 1/2"	13 1/2"	N/A	N/A	N/A	N/A	N/A	N/A	N/A
CPWM0751C-A	37"	48 1/4"	13 1/2"	N/A	N/A	N/A	N/A	N/A	N/A	N/A
CPB050DC-A	26"	44 1/2"	13 1/2"	N/A	N/A	N/A	N/A	N/A	N/A	N/A
CPBM050DC-A**	26"	44 1/2"	13 1/2"	N/A	N/A	N/A	N/A	N/A	N/A	N/A
CPWM050DC-A**	26"	44 1/2"	13 1/2"	N/A	N/A	N/A	N/A	N/A	N/A	N/A
CPB075DC-A	37"	48 1/4"	13 1/2"	N/A	N/A	N/A	N/A	N/A	N/A	N/A
CPBM075DC-A**	37"	48 1/4"	13 1/2"	N/A	N/A	N/A	N/A	N/A	N/A	N/A
CPWM075DC-A**	37"	48 1/4"	13 1/2"	N/A	N/A	N/A	N/A	N/A	N/A	N/A
CPB100DC-A	34 1/2"	59"	21 1/4"	N/A	N/A	N/A	N/A	N/A	N/A	N/A
CPBM100DC-A**	34 1/2"	59"	21 1/4"	N/A	N/A	N/A	N/A	N/A	N/A	N/A
CPWM100DC-A**	34 1/2"	59"	21 1/4"	N/A	N/A	N/A	N/A	N/A	N/A	N/A
CPF060DC-A	39"	44 1/2"	14 1/2"	N/A	N/A	N/A	N/A	N/A	N/A	N/A
CPFM060DC-A**	39"	44 1/2"	14 1/2"	N/A	N/A	N/A	N/A	N/A	N/A	N/A
CPF075DC-A	39"	48 1/4"	14 1/2"	N/A	N/A	N/A	N/A	N/A	N/A	N/A
CPFM075DC-A**	39"	48 1/4"	14 1/2"	N/A	N/A	N/A	N/A	N/A	N/A	N/A
CPF100DC-A	36 1/2"	59"	21 1/4"	N/A	N/A	N/A	N/A	N/A	N/A	N/A
CPFM100DC-A**	36 1/2"	59"	21 1/4"	N/A	N/A	N/A	N/A	N/A	N/A	N/A
CPF150DC-A	36 1/2"	59"	21 1/4"	N/A	N/A	N/A	N/A	N/A	N/A	N/A
CPFM150DC-A**	36 1/2"	59"	21 1/4"	N/A	N/A	N/A	N/A	N/A	N/A	N/A
CPX100DC-A	39"	48 1/4"	14 1/2"	N/A	N/A	N/A	N/A	N/A	N/A	N/A
CPXM100DC-A**	39"	48 1/4"	14 1/2"	N/A	N/A	N/A	N/A	N/A	N/A	N/A
CPX150DC-A	36 1/2"	59"	21 1/4"	N/A	N/A	N/A	N/A	N/A	N/A	N/A
CPXM150DC-A**	36 1/2"	59"	21 1/4"	N/A	N/A	N/A	N/A	N/A	N/A	N/A
CPX151DC-A	36 1/2"	59"	21 1/4"	N/A	N/A	N/A	N/A	N/A	N/A	N/A
CPB050DCO-A	32"	44 1/2"	14 7/8"	N/A	N/A	N/A	N/A	N/A	N/A	N/A
CPB075DCO-A	43"	48 1/4"	14 7/8"	N/A	N/A	N/A	N/A	N/A	N/A	N/A
CPB100DCO-A	40 1/2"	59"	22 7/8"	N/A	N/A	N/A	N/A	N/A	N/A	N/A
CPF060DCO-A	43"	44 1/2"	15 7/8"	N/A	N/A	N/A	N/A	N/A	N/A	N/A
CPF075DCO-A	43"	48 1/4"	15 7/8"	N/A	N/A	N/A	N/A	N/A	N/A	N/A
CPF100DCO-A	40 1/2"	59"	22 7/8"	N/A	N/A	N/A	N/A	N/A	N/A	N/A
CPF150DCO-A	40 1/2"	59"	22 7/8"	N/A	N/A	N/A	N/A	N/A	N/A	N/A
CPF151DCO-A	40 1/2"	59"	22 7/8"	N/A	N/A	N/A	N/A	N/A	N/A	N/A
CPB050DW	N/A	N/A	N/A	25 1/4"	38 1/4"	22 1/4"	27 3/8"	34 3/8"	43"	46 3/8"
CPB075DW	N/A	N/A	N/A	44 1/8"	45"	30"	N/A	27 5/8"	36 1/4"	39 5/8"
CPB100DW	N/A	N/A	N/A	44 1/8"	45"	30"	N/A	27 5/8"	36 1/4"	39 5/8"
CPF060DW	N/A	N/A	N/A	25 1/4"	38 1/4"	22 1/4"	27 3/8"	34 3/8"	43"	46 3/8"
CPF075DW	N/A	N/A	N/A	25 1/4"	38 1/4"	22 1/4"	N/A	34 3/8"	43"	46 3/8"
CPF100DW	N/A	N/A	N/A	44 1/8"	45"	30"	N/A	27 5/8"	36 1/4"	39 5/8"
CPF150DW	N/A	N/A	N/A	44 1/8"	45"	30"	N/A	27 5/8"	36 1/4"	39 5/8"
CPX100DW	N/A	N/A	N/A	25 1/4"	38 1/4"	22 1/4"	N/A	34 3/8"	43"	46 3/8"
CPX150DW	N/A	N/A	N/A	44 1/8"	45"	30"	N/A	27 5/8"	36 1/4"	39 5/8"
CPX151DW	N/A	N/A	N/A	44 1/8"	45"	30"	N/A	27 5/8"	36 1/4"	39 5/8"
CPB050DWO	N/A	N/A	N/A	25 1/4"	42"	22 3/4"	27 3/8"	34 3/8"	43"	46 3/8"
CPB075DWO	N/A	N/A	N/A	44 1/8"	48 3/4"	30 1/2"	N/A	27 5/8"	36 1/4"	39 5/8"
CPB100DWO	N/A	N/A	N/A	44 1/8"	48 3/4"	30 1/2"	N/A	27 5/8"	36 1/4"	39 5/8"
CPF060DWO	N/A	N/A	N/A	25 1/4"	42"	22 3/4"	27 3/8"	34 3/8"	43"	46 3/8"
CPF075DWO	N/A	N/A	N/A	25 1/4"	42"	22 3/4"	N/A	34 3/8"	43"	46 3/8"
CPF100DWO	N/A	N/A	N/A	44 1/8"	48 3/4"	30 1/2"	N/A	27 5/8"	36 1/4"	39 5/8"
CPF150DWO	N/A	N/A	N/A	44 1/8"	48 3/4"	30 1/2"	N/A	27 5/8"	36 1/4"	39 5/8"
CPF151DWO	N/A	N/A	N/A	44 1/8"	48 3/4"	30 1/2"	N/A	27 5/8"	36 1/4"	39 5/8"

*Consideration must be given to accessibility for service & free condenser air flow. Consult Factory.
**Not E.T.L. or C.S.A. listed
Subject to change without notice

STANDARD FEATURES

SHELVING KITS

Shelving kits specifically designed for Nor-Lake Mini-Rooms and Environmental Rooms are offered as an optional extra. These kits are shipped with all the necessary components. The shelving sets are coded to correspond to the walk-in configuration ordered and are offered in either 3,4,5 or 6 tiers.

Two Types of Shelving Systems Are Available From Nor-Lake.

A. Nor-Lake Standard Chrome Kote™ Shelving.

B. Green Kote™ Shelving-Green epoxy coated shelves. 15 year guarantee against corrosion.

Shelving system construction is identical. Select the shelving FINISH of your choice.

Shelving posts are engineered for maximum strength. Shelves are adjustable on 2" centers. All shelves are N.S.F. listed. Special clips are utilized to gain the maximum square footage of storage space for each model. 14", 18" and 24" wide shelves are used as required for maximum storage capacity in each set. This wire shelving is ideal for scientific, laboratory and industrial applications.

SHELVES:

Shelves to have #9 (.148") gauge crosswires spaced 3/4" on centers with crossbraces 1/4" (.192") minimum of 4-3/4" on center.

Shelf Frames

Channel to be 9/16" x 1" x .075" thick.

Shelf Collars

A round tapered 1-5/16" high steel collar to be welded at each corner.

FINISHES

A. Chrome Kote™: Plated quality wire and steel. Surface nickel chrome plated.

B. Green Kote™: Electrostatically applied green baked epoxy over zinc steel and brite basic wire. Thickness: 4-7 mill.

POSTS

Posts to be .062" thick 1" O.D. round tubing notched every 2" on each corner of the post.

POST LEVELER

Installed on the bottom of each post is nylon housing for a steel leveler 3/8"-16 x 1-3/4".

FINISHES

A. Chrome Kote™: Plated quality wire and steel. Surface nickel chrome plated.

B. Green Kote™: Electrostatically applied green baked epoxy over green zinc steel and brite basic wire. Thickness: 2-3 mill.

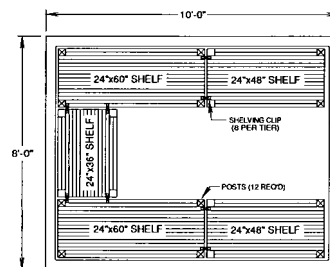
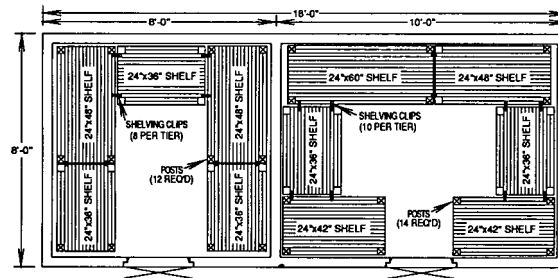
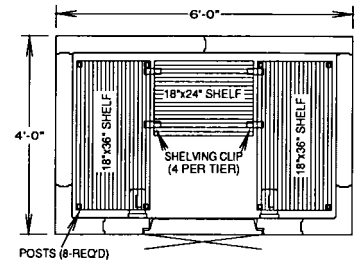
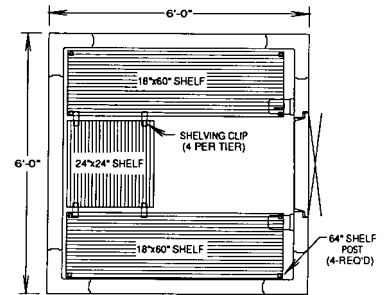

Nor-Lake, Scientific
 727 Second Street
 Hudson, Wisconsin 54016
800-477-5253
 715-386-2323
 800-388-5253 PARTS
 715-386-4290 FAX
 www.norlake.com
 Part No. 079360
 4/02

DOOR

Door sections manufactured at Nor-Lake are factory tested to assure proper fit, performance and alignment. All doors feature a stepped profile design that serves as a barrier to air flow which results in an energy efficient door system.

Each Mini-Room walk-in compartment is equipped with a 26" wide door. The height of the door opening varies with the series of Mini-Room walk-in ordered. The 45 Series has a 59" high door, the Standard Series (6'7" high) has a 66" high door and the 74 and 77 Series Mini-Room walk-ins have a 78" high door. The door is self-closing, flush mounted, infitting and constructed to incorporate heavy duty, molded ABS breaker which is permanently foamed-in-place.

Doors are available with right or left side hinges and include two cam-lift hinges, magnetic gasket, double sweep gasket, posi-close door closer, NL 9800 deadbolt locking handle with independent key/padlock feature and inside safety release. The doors are prehung in a four foot wide frame panel which is equipped with replaceable perimeter heater wire, magnetic stainless steel trim, 2-1/2" dial thermometer, vapor-proof light fixture with constant burning interior night light, and switch with exterior pilot indicator light.

The door section is completely pre-wired within concealed conduit inside the door frame panel. 115/60/1 electrical is field wired to a junction box which is surface mounted on the interior frame above the vapor proof light fixture.

Hinges and door handle are mounted to 1/2" synthetic insulated tapping plates. Each door section is complete with a heavy gauge galvanized steel heated threshold.

FLOOR CONSTRUCTION

Floor panels (when supplied) are similar in construction to the wall panels except they are made to withstand uniformly distributed floor loads of up to 600 pounds per square foot. The interior floor metal is smooth aluminum.

The 74 Series, floorless models, are supplied with a patented vinyl floor sealer to stop conductivity at floor level. This unique sealer sits flat on existing floors and fits tightly against the interior/exterior wall panels. The walk-in wall panel is supported on the shoulder of the sealer so the foam edge is free of compressing weight. The vinyl floor sealer is NSF listed.

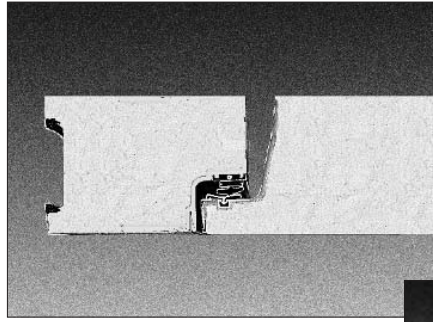

DOORS FEATURE A STEPPED PROFILE DESIGN



VAPOR PROOF LIGHT FIXTURE



VIEWPORT

Heated viewport (14" x 14") option offers unobstructed view of interior and contents without having to open the door, thus protecting products or experiments sensitive to temperature changes.



DEADBOLT LOCKING HANDLE

NL 9800 deadbolt locking handle with independent key/padlock feature and inside safety release.

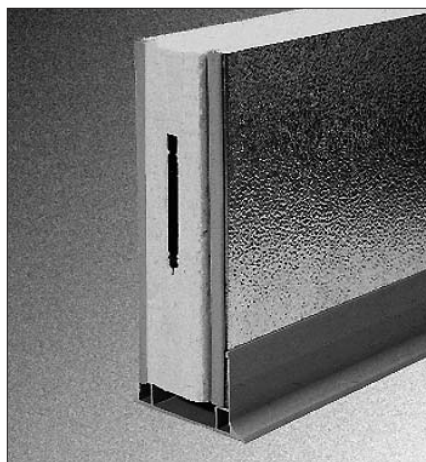

FLOORLESS MODELS ARE SUPPLIED WITH A PATENTED VINYL FLOOR SEALER.

MINI-ROOM WALK-IN SIZES AVAILABLE

SINGLE COMPARTMENT SIZES

The 45 Series is available in one size which is 4' wide x 5' long x 6'-0" high. This model is supplied with a walk-in floor.

The Standard Series of Mini-Room walk-ins are all 6'-7" high and are all supplied with a floor. The sizes available are as follows: 4' wide x 6' long, 6' wide x 6' long, 6' wide x 8' long, 6' wide x 10' long, 6' wide x 12' long, 8' wide x 8' long, and 8' wide x 10' long.

The 77 Series of Mini-Room walk-ins are all 7'-7" high and are all supplied with a floor. The sizes available are as follows: 6' wide x 6' long, 6' wide x 8' long, 6' wide x 10' long, 6' wide x 12' long, 8' wide x 8' long, and 8' wide x 10' long.

The 74 Series of Mini-Room walk-ins are all 7'-3 5/8" high and are all supplied without a floor. Wall panels are installed on top of N.S.F. listed vinyl sealers provided. The sizes available are as follows: 6' wide x 6' long, 6' wide x 8' long, 6' wide x 10' long, 6' wide x 12' long, 8' wide x 8' long, and 8' wide x 10' long.

COMBINATION MINI-ROOM COMPARTMENT SIZES:

The Mini-Room combination refrigerator/freezer line is available in 6'-7" high and 7'-7" high models and are all supplied complete with a floor. All models are available in two widths, 6' wide and 8' wide. The overall length of the combination Mini-Room is determined by the size of the refrigerator compartment and freezer compartment desired. The available sizes are the same as available in their mating single compartment models.

EXAMPLE #1: If you have determined that you need a 6' wide combination model your choices for refrigerator and freezer compartment lengths are 6', 8', 10', and 12'. Therefore, if you desire both refrigerator and freezer to have lengths of 8' your overall combination dimensions will be 6' wide x 16' long.

EXAMPLE #2: If you have determined that you need a 8' wide combination model your choices for refrigerator and freezer compartment lengths are 6', 8', and 10'. Therefore, if you desire the refrigerator to be 8' long and the freezer to be 6' long, your overall combination dimensions will be 8' wide x 14' long.



WALK-IN SPECIFICATIONS

Mini-Room walk-ins are built of modular panels, and are insulated with foamed-in-place polyurethane insulation. Each panel is designed to ensure ease of installation, long term reliability and high insulating efficiency.

A. All panels are manufactured with male and female mating rails to ensure proper alignment during installation. The polyurethane insulation wraps around the return bend metal seams on both sections to create a lightweight panel of exceptional strength and durability. All panels are a full four (4) inches thick and provide a superior insulating value.

B. The foamed-in-place cam locking fasteners ensure an airtight seal for maximum energy efficiency.

C. Mini-Room panel gaskets around the outer perimeter of the panel are continuous, without cuts or breaks at corners. The Nor-Lake patented gasket design provides a foamed-in-place gasket as an integral part of the panel. Gaskets cannot fall off or pull off during shipment or installation.

D. Panels lock together tightly to assure an energy efficient walk-in.

E. Edge caps for ends of floor and ceiling panels are foamed-in-place rather than overlapped or mechanically fastened. Edge caps cannot come loose, and they stay in place through the life of the walk-in.

F. Panel Finishes:
Interior and exterior complete to be 26 gauge embossed galvanized with aluminum coating. Models supplied with a floor will include smooth aluminum interior floor surface.

Insulation

Panels to be four (4) inches thick, metal clad and foamed-in-place with high density polyurethane insulation.

Optional Features

G. Duplex receptacles are foamed-in-place and flush mounted with the panel surface with all electrical wiring foamed-in-place behind the panel skin for safety, aesthetics, and professional appearance.

H. Hi/Lo Alarm provides accurate temperature monitoring with easy to read LED display and audible alert when temperature is out of tolerance.

I. The Nor-Lake Scientific family of control panels offers a variety of control needs including temperature monitoring of air and product temperatures, monitoring in °C or °F, adjustment of temperature, documentation of temperature on chart recorders and audible and visual alarms when temperature is out of specification. The advanced control provides at +/- 0.15°C. and +/- 1.0% accuracy.

Other features of the control panel are emergency shutdown switch, easily adjustable air and product Hi/Lo temperature and alarm settings, key lock door for security, touch pad programming, easy to read alphanumeric displays, dry contacts for remote alarm and power failure alarm.

Custom designed control panels are available for unique applications.

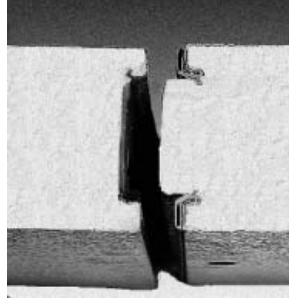

A.

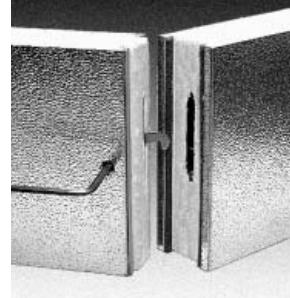

B.

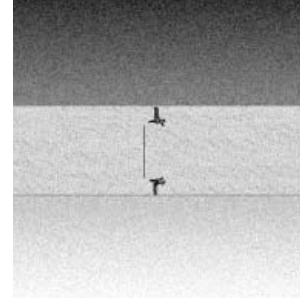

C.

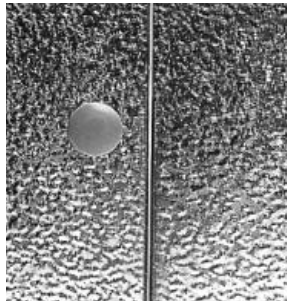

D.



E.

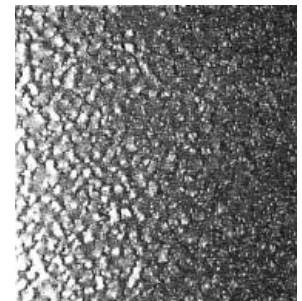

F.



G.



H.



I.